

ACTUATOR SHOWN AT MIDSTROKE

REVISION TABLE					
REV	ECN#	DESCRIPTION	REV BY	APPROVED	DATE
A	---	Original Drawing	JRM	MPW	10-04-08

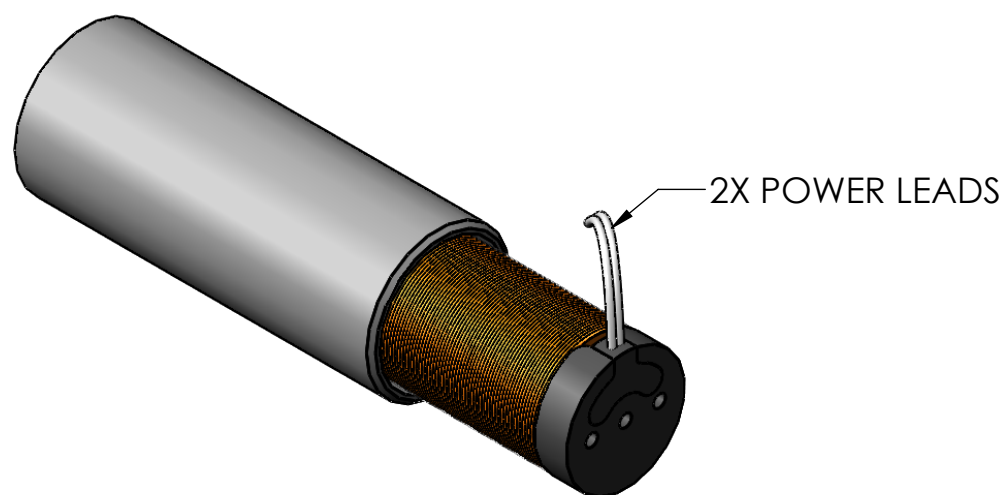
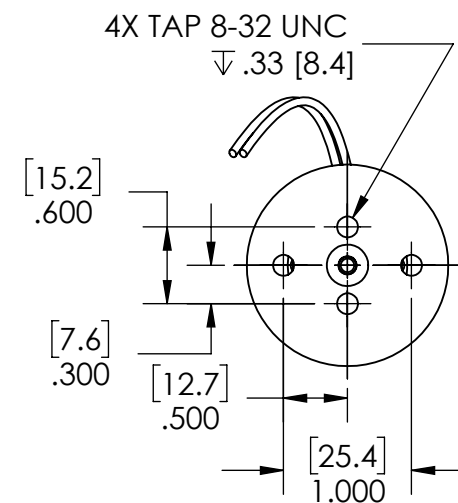
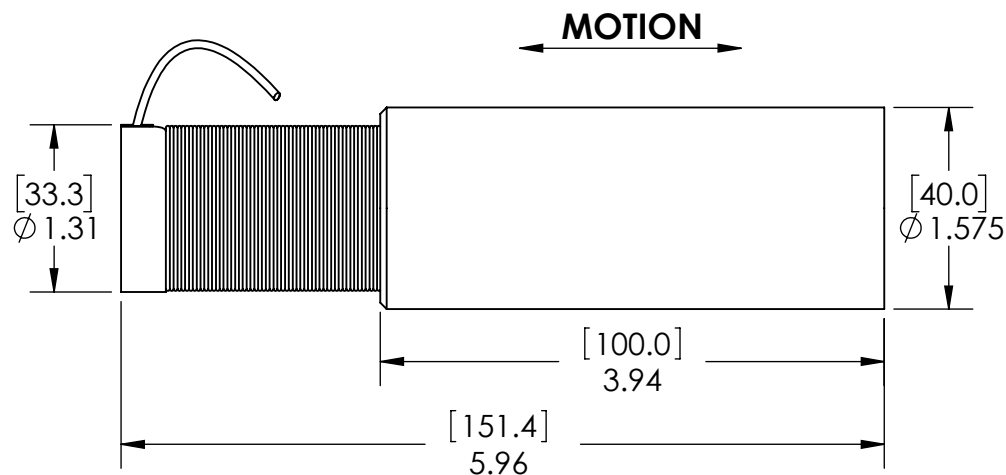
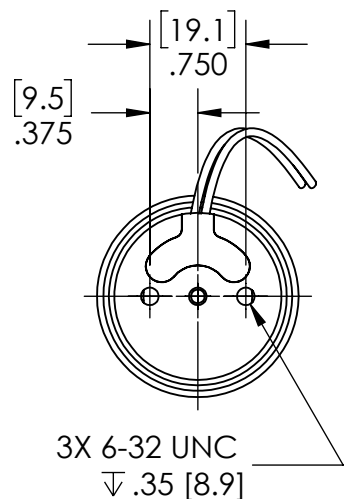

H2W Technologies, Inc.
Santa Clarita, CA 91350 USA
Tel: (661) 291-1620
www.h2wtech.com

These drawings and specifications are the property of H2W Technologies, Inc. They are issued in confidence and shall not be reproduced, copied, or used without written permission from H2W Technologies, Inc.

UNLESS SPECIFIED OTHERWISE:
All dimensions are in inches
Standard Tolerances are as follows
.XXX \pm .005 ANGLES \pm 1°
.XX \pm .010 FILLETS .010
.X \pm .020 CORNERS .010
Remove All Burrs and Sharp Edges

**FOR
REFERENCE
ONLY**

MATERIAL

FINISH

TITLE

**Voice Coil Actuator
Model #: NCC34-16-020-1X**

DWG # **30-0661**
REV **A**
DATE 02-04-08 SHEET 1 of 2

1

2

3

4

5

A

A

B

B

C

C

D

D

MOVING COIL NON-COMM ACTUATOR SPECIFICATIONS

Motor P/N	NCC34-16-020-1X	
Stroke	3.35"	85 mm
Radial Clearance	0.035" per side	0.90 mm per side
Bearing Type	None Provided	
Moving Mass	0.61 lbs	279 grams
Total Mass	1.72 lbs	780 grams
Resistance @ 20C	7.6 ohms	
Inductance @ 20C	3.8 mH	
Electrical Time Constant	0.50 msec	
Motor Constant	0.49 LBS/SQRT(Watt)	2.2 N/SQRT(Watt)
Force Constant	1.4 LBS/Amp	6.1 N/Amp
Back EMF	0.15 V/ips	6.1 V/m/sec
Continuous Force	2.0 LBS	8.9 N
Max Power @ 100% Duty	17 Watts	
Peak Force	6.0 LBS	26.7 N
Max Power @ 10% Duty	150 Watts	



H2W Technologies, Inc.
 Santa Clarita, CA 91350 USA
 Tel: (661) 291-1620
www.h2wtech.com

These drawings and specifications are the property of H2W Technologies, Inc. They are issued in confidence and shall not be reproduced, copied, or used without written permission from H2W Technologies, Inc.

UNLESS SPECIFIED OTHERWISE:
 All dimensions are in inches
 Standard Tolerances are as follows
 .XXX ±.005 ANGLES ±.1°
 .XX ±.010 FILLETS .010
 .X ±.020 CORNERS .010
 Remove All Burrs and Sharp Edges

**FOR
REFERENCE
ONLY**

MATERIAL

FINISH

TITLE

Voice Coil Actuator
 Model #: NCC34-16-020-1X

DWG #

30-0661

REV

A

DATE

02-04-08

SHEET

2 of 2